

Installing the Heater Welder Assembly

Maintenance and service tasks may require you to remove or replace PN# 61479636, the Heater Welder Assembly. The Heater Welder Assembly is part of the Cut Weld Assembly located at the east end (supply end) of the printer. The following steps walk you through the removal and the replacement of the Heater Welder Assembly. Any paper in the paper path will be exposed during this procedure.

The Heater Welder Assembly

Completed View of the Assembly

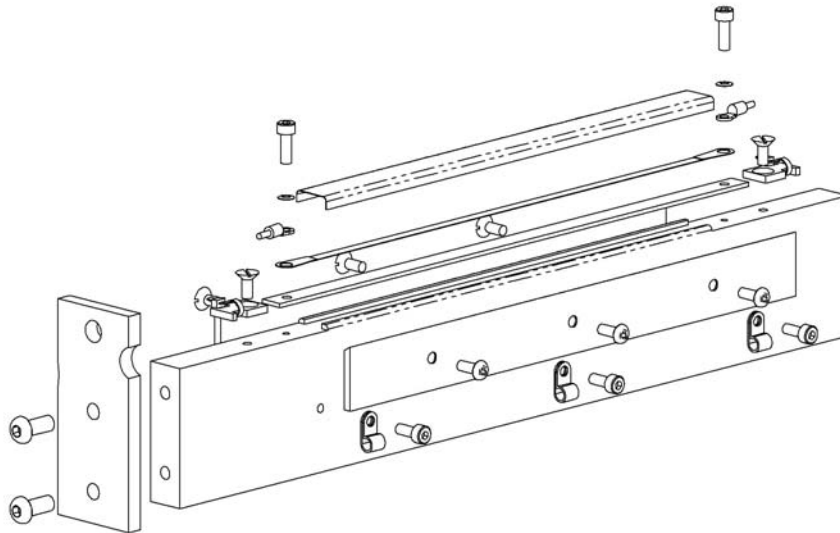
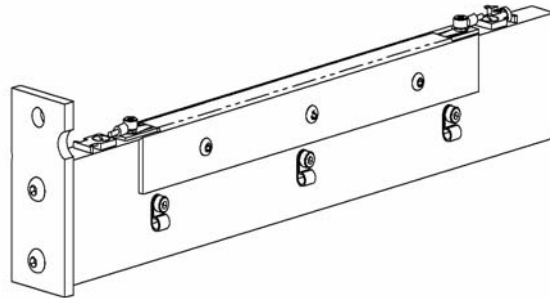

Exploded View of the Assembly

To Remove the Heater Welder Assembly

To remove the Heater Welder Assembly, open up the printer and disconnect the terminal lugs from the Welder Power Controller. Slide the Heater Welder Assembly out the blue (back) side of the Cut Weld Assembly.

Tools you will need:

- Phillips screwdriver
- 4mm hex driver, or allen wrench
- 5mm hex driver, or allen wrench.

1. Turn the Europa off completely.
2. Remove the three front panels and the three back panels of the printer. Set aside. Figure 1.



Figure 1. Remove front and back panels to access the paper path.

3. Remove the two M8 screws that attach the Cut Weld Assembly cover to the frame. Set Aside. Figure 2.



Figure 2. Remove the Cut Weld Assembly cover.

- Remove the two 6-32 x 1/4 panhead screws on the Ground and +5V terminals on PN# 70311954, Welder Power Controller. Disconnect the two cables. Figure 3.

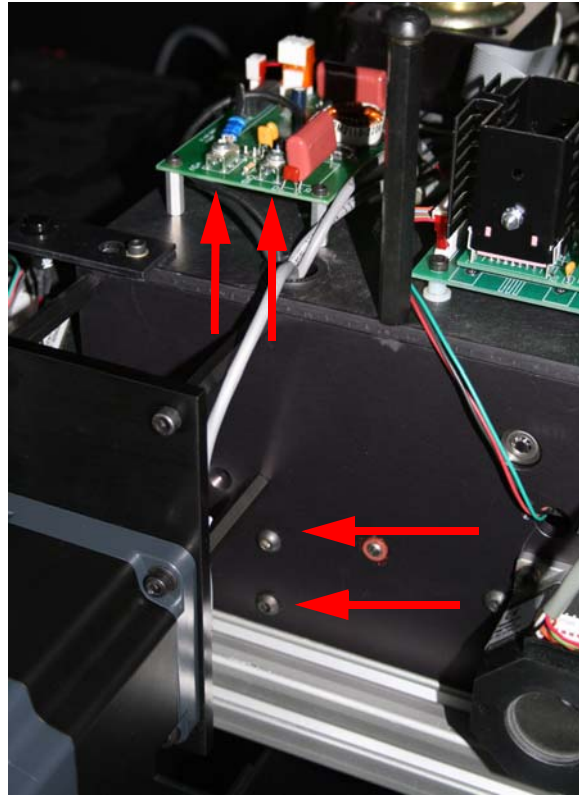

Figure 3. Disconnect the terminal lugs from the Welder Power Controller. Remove the two screws.

Table 1: 70311954 PCB Assy, Welder Power Controller

Location	Description	Destination	Cable PN#
J1	2 conductor, grey shielded (red & black)	Power Distribution Bar, 48 V red = 48 V, black = 48 V return	45633833
J2	2 conductor, grey shielded (red & black)	J6/ PN# 41937754 Paper Deck Controller	35957058
GND	terminal lug, grey shielded	PN# 65928429, Heating Element, Welder, Blue End	75583050 *blue
+5V	terminal lug, grey shielded	PN# 65928429, Heating Element, Welder, Orange End	85142427 *orange

* cables are interchangeable

- Remove the two M6 screws from the orange side (front) of the Cut Weld Assembly. Figure 3.

6. Remove the M8 screw from the blue side (back) of the Cut Weld Assembly. Figure 4.

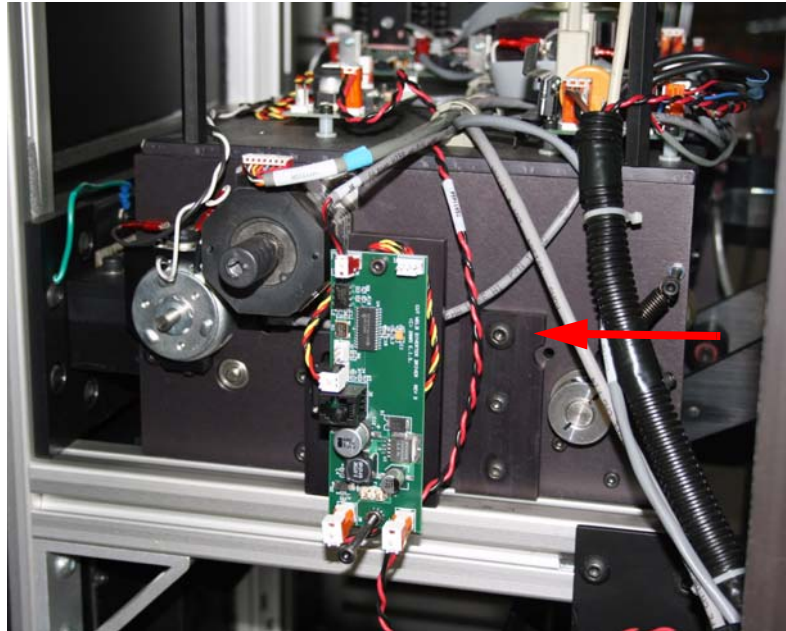

Figure 4. Remove the two M8 screws.

7. Remove the two M8 screws from under the Heater Welder Assembly. One screw per bracket. See figure 5.

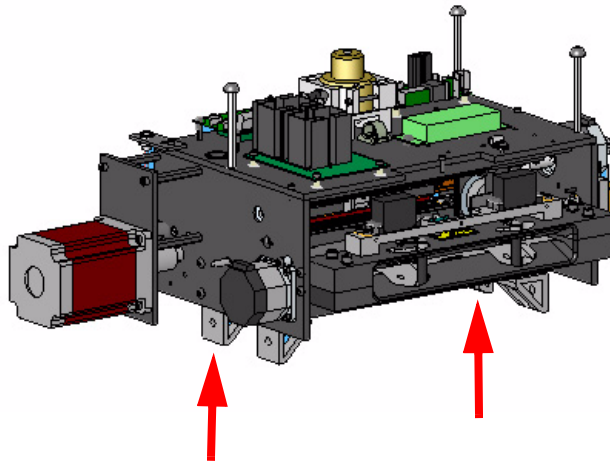

Figure 5. Remove the two M8 screws that secure the Heater Welder Assembly to the supporting brackets.

8. Pass the power and ground cables under the Welder Power Controller and push down through the top of the Cut Weld Assembly. This will prevent them from catching on the circuit board as you remove the Heater Welder Assembly. Figure 6.



Figure 6. Push the cables down through the top of the Cut Weld Assembly.

9. Slide the Heater Welder Assembly through the opening in the back of the Cut Weld Assembly. Figure 7.

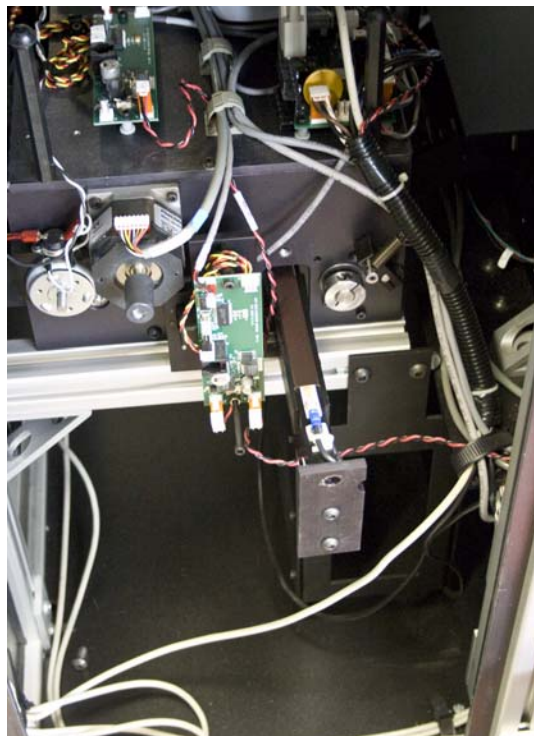

Figure 7. Slide the Heater Welder Assembly out the blue side of the Cut Weld Assembly.

10. Insert the new Heater Welder Assembly and thread the cables up through the top of the Cut Weld Assembly. Cautiously avoid pinching or trapping surrounding cables.
11. Replace the two M6 screws on the orange side of the Cut Weld Assembly and replace the M8 screw on the blue side of the Cut Weld Assembly. Leave the screws loose. Figure 3 & 4.
12. Replace the two M8 screws that fasten the Heater Welder Assembly to the supporting brackets underneath. Place one hand up through the slack loop box to help hold the screw and driver in place. Figure 5.
13. Finish tightening all screws.
14. Replace the Welder Power Controller terminal lugs using the two phillips head screws. Figure 3.
15. Replace the Cut Weld Assembly cover.
16. Replace the three front panels and the three back panels. Figure 2.
17. Power on and resume operations.
18. Test the welder by cutting and welding the paper several times. Use the Paper button in the Operator Interface to access Cut and Weld commands.
19. Send any defective parts back to Express Imaging Systems. If you do not already have an RMA number please call 206-720-1798 and ask for one.